

HYUNDAI

Network Fixed Bullet Camera

HYU-CC-CIBF14003-C

User quick guide



- Please read this manual carefully before using the product you purchase and keep it well for future use.
- Please note that images and sketch maps in this manual may be different from the actual product.

Disclaimer

The default password is used for your first login. To ensure account security, please change the password after your first login. You are recommended to set a strong password (no less than eight characters).



- To the maximum extent permitted by applicable law, the product described, with its hardware, software, firmware and documents, is provided on an "as is" basis.
- Best effort has been made to verify the integrity and correctness of the contents in this manual, but no statement, information, or recommendation in this manual shall constitute formal guarantee of any kind, expressed or implied. We shall not be held responsible for any technical or typographical errors in this manual. The contents of this manual are subject to

change without prior notice. Update will be added to the new version of this manual.

- Use of this manual and product and the subsequent result shall be entirely on your own responsibility. In no event shall we be reliable to you for any special, consequential, incidental, or indirect damages, including, among others, damages for loss of business profits, business interruption, or loss of data or documentation, or product malfunction or information leakage caused by cyber attack, hacking or virus in connection with the use of this product.
- Video and audio surveillance can be regulated by laws that vary from country to country. Check the law in your local region before using this product for surveillance purposes. We shall not be held responsible

for any consequences resulting from illegal operations of the device.

- The illustrations in this manual are for reference only and may vary depending on the version or model. As a result, some of the examples and functions featured may differ from those displayed on your monitor.
- This manual is a guide for multiple product models and so it is not intended for any specific product.
- Due to uncertainties such as physical environment, discrepancy may exist between the actual values and reference values provided in this manual. The ultimate right to interpretation resides in our company.

Environmental Protection

This product has been designed to comply with the requirements on environmental protection. For the



proper storage, use and disposal of this product, national laws and regulations must be observed.

Safety and Compliance Information

Safety Symbols

The symbols in the following table may be found on installation-related equipment. Be aware of the situations indicated and take necessary safety precautions during equipment installation and



maintenance.

Symbol	Description
	Generators symbol: To suggest a generator safety concern.
	ESD protection symbol: To suggest electrostatic sensitive equipment.
	Electric shock symbol: To suggest a danger of high voltage.

The symbols in the following table may be found in this manual. Carefully follow the instructions

indicated by the symbols to avoid hazardous

situations and use the product properly.

Symbol	Description
	WARNING Indicates a hazardous situation which, if not avoided, could result in bodily injury or death.
	CAUTION Indicates a situation which, if not avoided, could result in damage to the product.
	NOTE Indicates useful or supplemental information about the use of product.

Safety Information

Installation and removal of the unit and its accessories must be carried out by qualified personnel. Please read all of the safety instructions below before installation and operation.

Installation

- This device is a class A product and may cause radio interference. Take measures if necessary.
- Make sure the power supply voltage is correct before using the camera.
- Do not drop the camera or subject it to physical shock.
- Do not touch sensor modules with fingers. If cleaning is necessary, use a clean cloth with a bit of ethanol and wipe it gently. If the camera will not be used for an extended period of time, put on the lens cap to protect the sensor from dirt.
- Do not aim the camera lens at the strong light such as sun or incandescent lamp. The strong light can cause fatal damage to the camera.

- The sensor may be burned out by a laser beam, so when any laser equipment is being used, make sure that the surface of the sensor not be exposed to the laser beam.
- While shipping, the camera should be packed in its original packing.

Maintenance

- If there is dust on the front glass surface, remove the dust gently using an oil-free brush or a rubber dust blowing ball.
- If there is grease or a dust stain on the front glass surface, clean the glass surface gently from the center outward using anti-static gloves or an oil-free cloth. If the grease or the stain still cannot be removed, use anti-static gloves or an oil-free cloth dipped with detergent and clean the glass surface gently until it is removed.

Do not use organic solvents, such as benzene or ethanol when cleaning the front glass surface.



- Never look at the transmit laser while the power is on. Never look directly at the fiber ports and the fiber cable ends when they are powered on.
- Use of controls or adjustments to the performance or procedures other than those specified herein may result in hazardous laser emissions.

Regulatory Compliance

FCC Part 15

This equipment has been tested and found to comply with the limits for digital device, pursuant to part 15 of the FCC Rules. These limits are designed to provide reasonable protection against harmful interference when the equipment is operated in a commercial environment. This equipment generates, uses, and can radiate radio frequency energy and, if not installed and used in accordance with the instruction manual, may cause harmful interference to radio communications. Operation of this equipment in a residential area is likely to cause harmful interference in which case the user will be required to correct the interference at his own expense.

This product complies with Part 15 of the FCC Rules. Operation is subject to the following two conditions:

1. This device may not cause harmful interference.

2. This device must accept any interference received, including interference that may cause undesired operation.

LVD/EMC Directive



This product complies with the European Low

Voltage Directive 2006/95/EC and EMC Directive

2004/108/EC.

WEEE Directive-2002/96/EC



The product this manual refers to is covered by the Waste Electrical & Electronic Equipment (WEEE) Directive and must be disposed of in a responsible manner

Contents

1 Packing List.....	1
----------------------------	----------

2 Appearance.....	2
--------------------------	----------

 Appearance and Operation..... 3

 Cable Connections..... 4

3 Mount Your Camera.....	3
---------------------------------	----------

 Mounting..... 3

 Mounting Bracket..... 4

 Mounting Bracket Mounting..... 5

 Mounting Brackets..... 6

4 Set Your Camera over the LAN.....	10
--	-----------

5 Access Your Camera.....	12
----------------------------------	-----------

 Access Your Camera..... 12

1 Packing List

No.	Item	Quantity
1	Camera	1
2	User document	1
3	Accessories	1

Contact your local dealer if the package is damaged or incomplete.

2 Appearance

Dimensions and Appearance

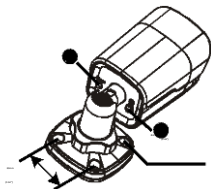

Cable Connection

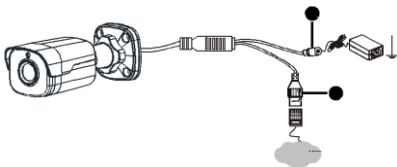

No.	Description	No.	Description
•	RESET button	•	Earth terminal
•	Power interface	•	Network interface



• For specifications, see the latest product data sheets.

• Press and hold the RESET button for at least

10 seconds to restore factory default

settings. Performance operation within 10 minutes after the device is powered on or the reset will fail otherwise.

3 Mount Your Camera

Wall Mount

You can adopt wall mount or ceiling mount and purchase hardware accessories by yourself. The

following part takes wall mount as an example. Ceiling mount is similar to wall mount and therefore is omitted here.

2. Locate the position of the value.

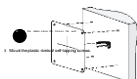

Make the public realize the public have understood that this assignment is



2. Drill holes into the wall.



4. *Disseminate* is to spread the universal joy of watching your camera roll well.



5. Mount your camera onto the wall and connect all cables.

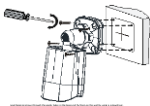

Make sure you mount the camera onto the bracket before you start using your camera.

6. Adjust the

monitoring direction.

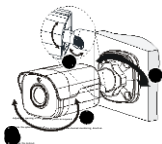

7. Power on your camera and adjust images.



The grounding installation process is for connected installations, during which holes are punched on the wall and cables are penetrated into the wall. If open installation is adopted, cables are not penetrated into the wall but threaded out from the outlet on one side of the base.

Start Your Camera

After verifying that your camera is properly mounted, connect the power cable to it and the other end of the cable to the mains. Then start your camera.

Waterproof Components for an RJ45 Plug

1. Attach the end rings to the waterproof connector.



2. Mount the waterproof components.



3. Insert the cylindrical waterproof ring into the hole.



4. Insert the cable into the connector and secure the waterproof seal in.



5. Secure the waterproof seal.



6. Finish the waterproof installation.





In step 2, you can strip the inner wires of the cable with the RJ45 plug first and then cover the waterproof components. You may also cover the waterproof components.

Waterproof Tail Cable

Connect the tail cables and then take the following steps to protect the tail cables from water using waterproof tapes. The figures are only for illustration purpose.

1. Connect the tail cables.

2. Protect the connected cables using insulating tapes.



3. Pinch other cables using insulating tapes.

4. Wrap all the cut cables together using insulating

tapes.

5. Connect a multi-point for using cut tapes.

6. Pinch the cut cables using using cut tapes.





- Avoid sharp stress when installing the cables.
- Use self-adhesive waterproof tapes that will stick together with the twisted cables.
- Tighten waterproof tapes when wrapping the cables and make sure the cable connections are fully covered.
- You are recommended to put the waterproof cables in a waterproof junction box which needs to be purchased separately.

4 Set Your Camera over the LAN

To view and configure your camera via the LAN (Local Area Network), you need to install the EZStation to find your camera and change its IP address.



• Please contact your dealer to get the EZStation.

• Please refer to the user manual of EZStation for detailed information.

1. Connect your camera and your PC as shown in the figure below to ensure the routing is available.



2. Use EZStation to search online cameras automatically.
3. Modify your camera settings if necessary, including its IP address and subnet mask.



- The default IP address is "192.168.0.13". The default username is "admin" and the default password is "1234567".
- To access your camera from a different subnet, set the gateway for your camera after you login.

5 Access Your Camera

Access Your Camera

Before you begin, check that:

- Your camera is operating properly and connected to the network.
- The PC you are using is installed with Internet Explorer 7.0 or later. IE 8.0 is recommended.

Follow these steps to access your camera through the Web interface:

1. Open your browser, input the IP address of your camera (default IP is 192.168.0.13) in the address bar and then press Enter to open the login page.
2. Enter the username (default is "admin") and password (default is "123456") and then click **Login**.



Install the default at your first login. For the detailed steps, see [Install the default](#). When the installation of the default is completed, open your IE to login.

Install the ActiveX

The following takes the IE browser as an example to describe the installation steps.

1. Click **Download**.



Failed to load ActiveX control, click **Download** to install latest ActiveX control.

2. Click **Run** to install the downloaded ActiveX.

You may also click **Save** to download the file to your computer first.

3. Close the browser and follow the steps to complete the installation.



- For your first login with Windows 7, if the system does not prompt you to install Intel®t, follow these steps to turn off UAC: click the Start button, and then click Control Panel. In the search box, type uac, and then click Change User Account Control Settings. Move the slider to the **Never Notify** position, and then click OK. After UAC is turned off, log in again.
- If the installation failed, open **Internet Options** in IE before login. Click the **Security** tab, click **Trusted sites**, and then click **Sites** to add the website. If you use Windows 7, you need to use the shortcuts to your PC first, and then right-click the file, select **Run as administrator**, and then install according to instructions.

HYUNDAI



For Inquiries, Please Contact:

Security Shop
Vladimira Popovica 6/6/A606
11070 Belgrade, Serbia
Tel: +381 11 318 68 68
office@macchina.rs

Imported/Distributed by Security Shop doo
Licensed by Hyundai Corporation Holdings, Korea
Delivery and After Service shall only be covered within Serbia