

User Manual

Wireless smoke sensor BP-WSMK01-868



Enjoy it.

1. Function introduction

The wireless smoke detector has a new voice prompt function, with a test button and a built-in speaker. It can accurately detect smoke. When the smoke concentration exceeds the limit, the smoke detector will sound and send an alarm signal to the host.

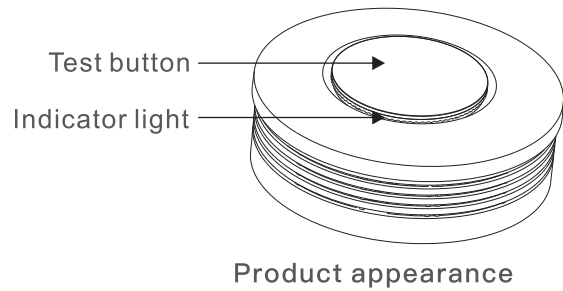

Product appearance

2. Technical indicators

Model number: BP-WSMK01-868

Working voltage: DC6V CR123A*2

Debugging method: FSK

Working frequency: 433MHz

Working environment: Temperature -5°C ~ +50°C, Humidity 10%-90%

Battery life: 2~3 years

Turn on self-inspection indication: After the red indicator light flashes, the voice prompts that the self-inspection is successful

Alarm output indication: Red LED indicator light is on for 5S, and the horn sounds

Low battery indication: Buzzer sounds once every two hours

Size: φ108*42.5mm

3. Installation

1. Notes:

- Do not install on vents (such as windows, doors, air conditioning inlets and outlets, etc.)
 - The distance from the light source and the corner of the wall should be kept at 50 cm away;
 - The installation location must be in a place that avoids heavy vapor, rain, dust and humidity;
- Installation height: $2m \leq H(\text{installation height}) \leq 12m$
 - Installation position: ceiling installation, as shown in the figure right.
 - Installation method.

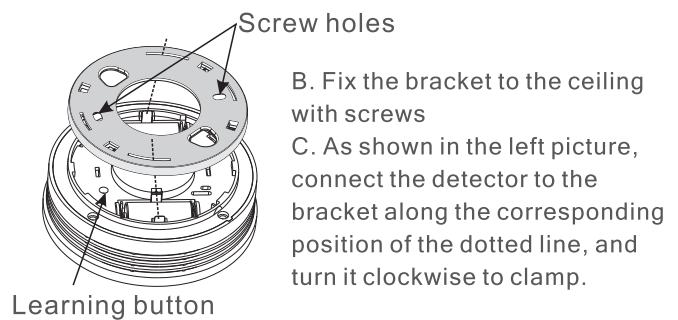
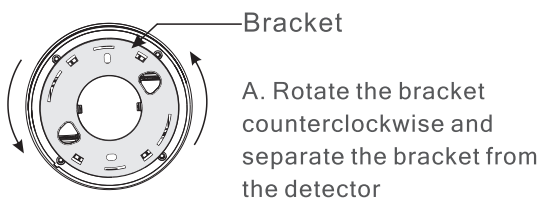

4. Battery replacement

When the detector's power is low, the detector's buzzer will sound once every two hours to give a reminder, and the battery should be replaced in time.

The replacement steps are as follows:

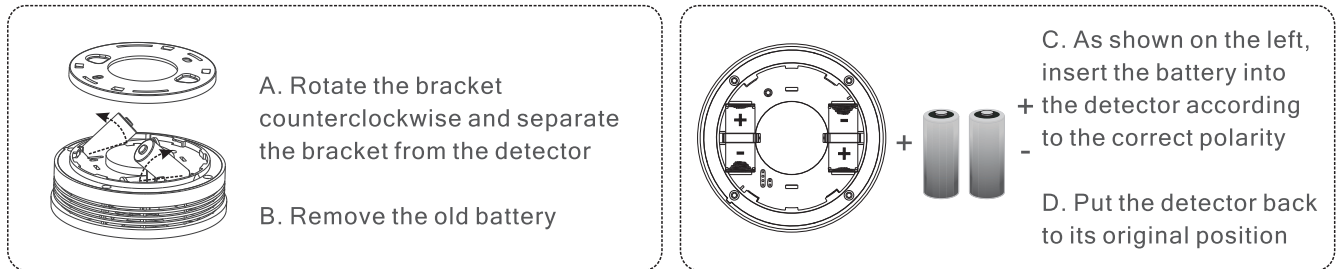

5. Learn to code

- Install the battery on the detector;
- Adjust the alarm host the learning code matching mode;
- Press the learning button on the back of the detector, the indicator light of the detector flashes stroboscopically, and the host automatically learns the code matching.

6. Product testing

After the detector is installed, it is already in the working state. In the working state, the LED light of the detector will flash once every minute. When the test button is pressed for self-test, the red indicator light will flash and the buzzer will sound twice.

7. Police handling

When the smoke in the ambient air exceeds the limit, the detector will alarm and send an alarm signal to the host. At this time:

- Check the source of smoke to see if it is on fire,
- Immediately open the window room to circulate the air,
- Extinguish all fire sources and avoid using all objects that can produce sparks (such as turning on a lighter, striking a match, etc.)
- Check the cause of the smoke and notify relevant departments and related professionals to deal with it in time. If the detector is falsely reported after inspection, the user should check whether the detector is installed properly.

8. Easy maintenance

Due to the long-term use of the detector, some pollutants will adhere to the convection window of the gas, which will affect the sensitivity of the detector. It is recommended that the user clean the detector every 3 months to maintain the working stability of the detector.

Do not let the cleaning fluid enter the body during cleaning, so as not to damage the electronic parts inside the body, please retest the detector after cleaning.

For Inquiries, Please contact:

Security Shop
Vladimira Popovica 6/6/A606
11070 Novi Beograd, Serbia
Tell: +381 11 318 68 68
office@securityshop.rs

Imported/Distributed by Security Shop doo
license of Blaupunkt
www.blaupunkt.com
Made in China